

Panasonic

CV-CFW203AL

Smart look Day/Night Fixed-Focal Dome Camera with IR illuminator



Specifications

Parameter	CV-CFW203AL
Camera	
Image Sensor	1/2.7 inch CMOS
Effective Pixels	1920(H) x 1080(V), 2MP
Min. Illumination	0.02Lux/F1.9, 30IRE, 0Lux IR on
Electronic Shutter	PAL : 1/25s - 1/100,000s NTSC : 1/30s - 1/100,000s
Video Frame Rate*	PAL : 25fps NTSC : 30fps
Day/Night	Auto/Color/ B/W
Max. IR Distance	30m
Smart IR	Yes
Digital Noise Reduction	2D
White Balance	Auto, manual
Gain Control	Auto, manual
BLC	BLC/HLC/DWDR
Lens	
Focal Length	3.6mm
Field of View	3.6mm: 100° x 84° x 45° (diagonal x horizontal x vertical)
Lens Type	Fixed-focal
Input/Output	
Video Output	1CH BNC HD-CVI video output
General	
Power	DC 12V±30%
Power Consumption	Max. 2.9W (DC 12V, IR on)
Working Temperature	-40°C - +60°C Less than 95% RH (non-condensation)
Dimensions	Φ109.9mm x 88.1mm
Weight (approx.)	330g
External Case	Metal dome, metal cover and plastic decorative ring

Key Features

- High-performance CMOS image sensor.
- Supports 1080p@25fps (PAL)/30fps (NTSC).
- Supports transmission up to 800m (1080P)/1200m (720P).
- High speed & long distance real-time transmission.
- Supports ICR for day time and night time operation.
- Supports auto exposure, auto white balance, auto electronic shutter and auto gain function.
- Supports DC12V power supply.
- IP66 compliance.

Standard Accessories

- Quick guide.....1 pc
- Important safety instruction.....1 pc

Appearance (mm [inch])

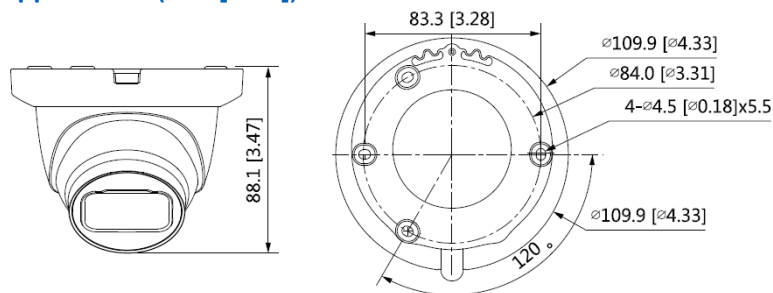

*Refer to DVR spec sheet for recording frame rate limitation

Important

- Safety Precaution: Carefully read the operating instruction manual before using this product.

- All pictures are simulated.
- Weights and dimensions are approximate.
- Specifications are subject to change without notice.
- These products may be subject to export control regulations.

DISTRIBUTED BY: